

READ BEFORE USE
LIRE AVANT UTILISATION
LEA ANTES DE USAR

Visit www.hamiltonbeach.com for our complete line of products and Use and Care Guides – as well as delicious recipes, tips, and to register your product online!

Rendez-vous sur www.hamiltonbeach.ca pour notre liste complète de produits et de nos manuels utilisateur – ainsi que nos délicieuses recettes et nos conseils !

¡Visite www.hamiltonbeach.com (EE. UU.) o www.hamiltonbeach.com.mx (México) para ver otros productos de Hamilton Beach o para contactarnos!

Questions?
Please call us – our friendly associates are ready to help.
USA: 1.800.851.8900

Questions ?
N'hésitez pas à nous appeler – nos associés s'empresseront de vous aider.
CAN : 1.800.267.2826

¿Preguntas?
Por favor llámenos – nuestros amables representantes están listos para ayudar.
EE. UU.: 1.800.851.8900
MEX: 01 800 71 16 100

Le invitamos a leer cuidadosamente este instructivo antes de usar su aparato.

Hamilton Beach®



Blender
Mélangeur
Licuadora

English	2
Français.....	11
Español	21

IMPORTANT SAFEGUARDS

When using electrical appliances, basic safety precautions should always be followed to reduce the risk of fire, electric shock, and/or injury to persons, including the following:

1. Read all instructions.
2. This appliance is not intended for use by persons (including children) with reduced physical, sensory, or mental capabilities, or lack of experience and knowledge, unless they are closely supervised and instructed concerning use of the appliance by a person responsible for their safety.
3. Close supervision is necessary when any appliance is used by or near children. Children should be supervised to ensure that they do not play with the appliance.
4. To protect against risk of electrical shock, do not put cord, plug, base, or motor in water or other liquid.
5. Unplug cord from outlet when not in use, before putting on or taking off parts, and before cleaning.
6. Avoid contact with moving parts.
7. Do not operate any appliance with a damaged cord or plug, or after the appliance malfunctions, or is dropped or damaged in any manner. Call our toll-free customer service number for information on examination, repair, or electrical or mechanical adjustment.
8. The use of attachments, including canning jars, not recommended or sold by the appliance manufacturer may cause a risk of injury to persons.
9. Do not use outdoors.
10. Do not let cord hang over edge of table or counter or touch hot surfaces, including stove.
11. Do not place on or near a hot gas or electric burner, or in a heated oven.
12. Keep hands and utensils out of the jar and away from the cutting blade, while blending or chopping food, to reduce the risk of severe personal injury and/or damage to the blender or chopper attachment (attachment may not be provided with blender). A rubber spatula may be used but must be used only when blender is not running.
13. Blades are sharp; handle carefully — especially when assembling, disassembling, or cleaning inside blender jar.
14. Do not use a broken, chipped, or cracked blender jar.
15. Do not use broken, cracked, or loose cutting blade assembly.
16. To reduce the risk of injury, never place cutting blade assembly on base without jar properly attached.
17. Always operate blender with lid in place.
18. When blending hot liquids, remove filler-cap and close the edge cover opening intended for pouring. To prevent possible burns: Do not exceed the 3-cup (710-ml) level. Hot liquids may push off lid during blending; therefore, with the protection of an oven mitt or thick towel, place one hand on top of the lid, keep exposed skin away from the lid, and start blending at lowest speed.
19. Ensure collar on base of blender jar is tight and secure. Injury can result if moving blades accidentally become exposed.
20. If the jar should twist or rotate when the motor is switched ON, switch OFF (O) immediately and tighten jar in collar or on blender base.
21. Do not leave blender unattended while it is operating.
22. If blender contains food chopper attachment, be certain the cover is securely locked in place before operating appliance.
23. Do not attempt to defeat the cover interlock mechanism.
24. To disconnect cord, turn the control to OFF (O). Then remove plug from wall outlet.
25. Do not use appliance for other than intended purpose.

SAVE THESE INSTRUCTIONS!

OTHER CONSUMER SAFETY INFORMATION

This product is intended for household use only. Use for food or liquids only.

WARNING! Shock Hazard: This appliance has a polarized plug (one wide blade) that reduces the risk of electric shock. The plug fits only one way into a polarized outlet. Do not defeat the safety purpose of the plug by modifying the plug in any way or by using an adapter. If the plug does not fit fully into the outlet, reverse the plug. If it still does not fit, have an electrician replace the outlet.

Wattage/Peak Power Information

The wattage/ampere rating of the blender is determined by an Underwriters Laboratory test and is based on available cutting blade assembly, jar combinations, and attachments that may not be provided with your unit, but are available as replacement parts. This is a measure of input wattage/amperes after 30 seconds of operation. The blender as provided may draw significantly less power.

Peak power is the measure of the motor wattage during the first seconds of operation. This is when a blender requires the most power to crush ice, frozen fruit, etc. This is a better measure of what a blender motor can consume when power is needed most.

The length of the cord used on this appliance was selected to reduce the hazards of becoming tangled in or tripping over a longer cord. If a longer cord is necessary, an approved extension cord may be used. The electrical rating of the extension cord must be equal to or greater than the rating of the appliance. Care must be taken to arrange the extension cord so that it will not drape over the countertop or tabletop where it can be pulled on by children or accidentally tripped over.

If the cutting blade assembly locks and will not move, it will damage the motor. Do not use. Call the toll-free customer service number for information.

Do not place blender jar in the freezer filled with food or liquid. This can result in damage to the cutting blade assembly, jar, — blender, and possibly result in personal injury.

BEFORE FIRST USE: After unpacking blender, wash everything except blender base in hot, soapy water. Dry thoroughly. Wipe blender base with a damp cloth or sponge. **DO NOT IMMERSE BASE IN WATER.** Care should be taken when handling cutting blade assembly as it is very sharp.

Parts and Features

*To order parts:

US: 1.800.851.8900

www.hamiltonbeach.com

Canada: 1.800.267.2826

Mexico: 01 800 71 16 100

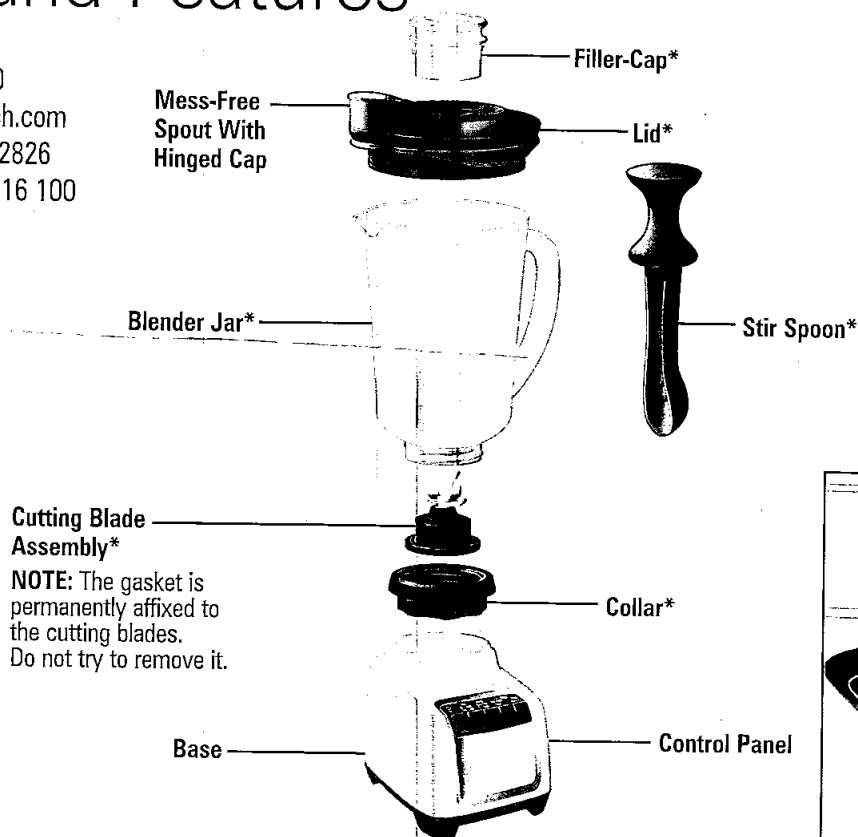

Cord Storage

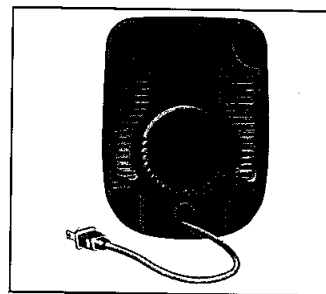

Control Panel

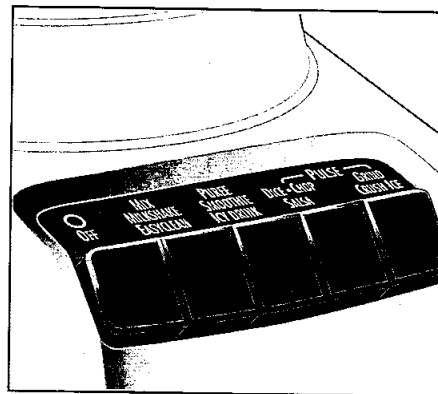

Using Your Blender

IMPORTANT: Your blender jar and cutting blade assembly are subject to wear during normal use. Always inspect jar for nicks, chips, or cracks. Always inspect cutting blade assembly for broken, cracked, or loose blades. If jar or cutting blade assembly is damaged, do not use. Call our toll-free customer service number to obtain replacement parts.

BEFORE FIRST USE: After unpacking the blender, follow the instructions in "Cleaning Your Blender."

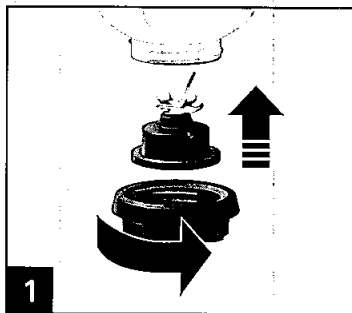

1

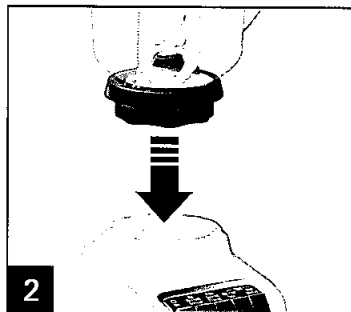

2

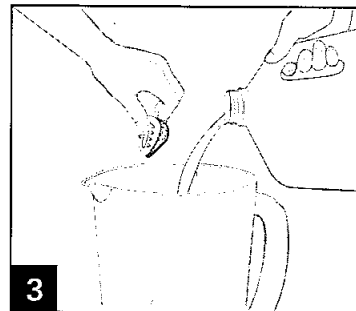

3

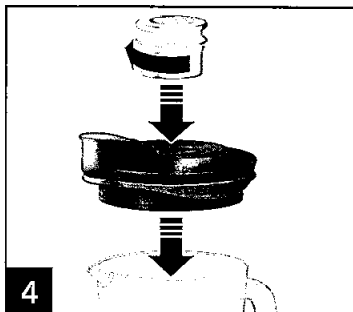

4

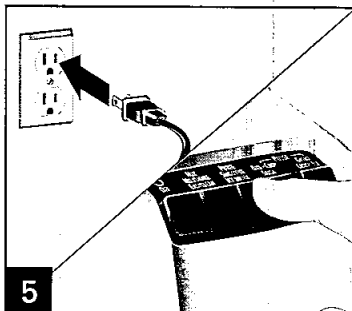

5

Push the desired speed button. When using the PULSE buttons, the blender will only run when the button is held down.

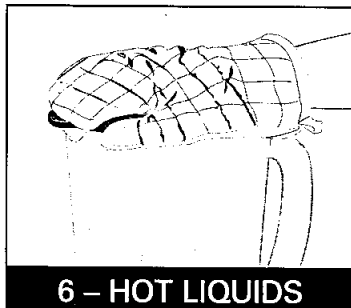

6 - HOT LIQUIDS

WARNING! Burn Hazard: When blending hot liquids, remove filler-cap and close the edge cover opening intended for pouring. To prevent possible burns: Do not exceed the 3-cup (710-ml) level. Hot liquids may push off lid during blending; therefore, with the protection of an oven mitt or thick towel, place one hand on top of the lid, keep exposed skin away from the lid, and start blending at lowest speed.

Using Your Blender (cont.)

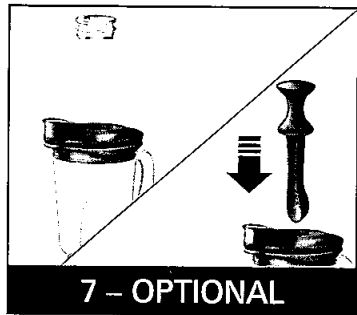

Remove filler-cap and insert stir spoon into hole in lid. Place one hand on top of the lid and use the stir spoon to add ingredients or to move thick mixtures around in blender jar. **NOTE:** Turn blender OFF (O) before removing filler-cap and when adding the stir spoon.

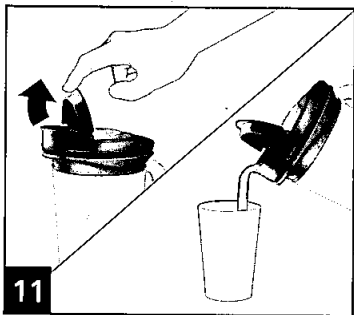
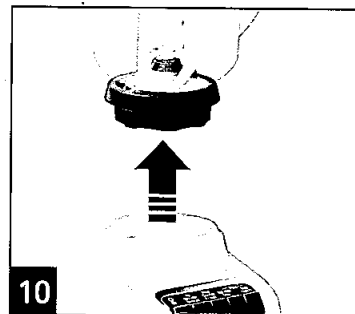
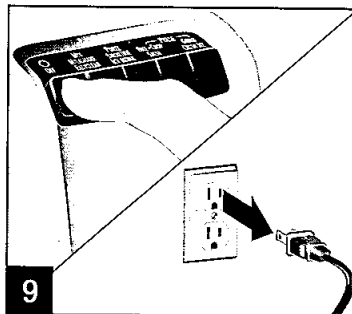
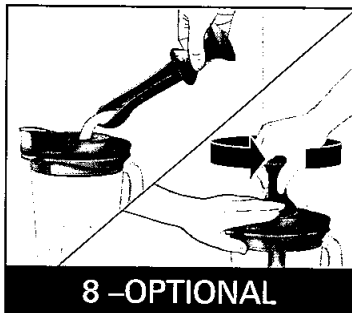

Blender Tips

- To add foods when blender is operating, remove filler-cap and add ingredients through the opening.
- If blending action stops during blending or ingredients stick to sides of the jar, insert stir spoon to help move the mixture around or add more liquid to the blender jar.
- Do not try to mash potatoes, mix stiff dough, whip egg whites, grind raw meat, or extract juices from fruits and vegetables.
- Do not store food or liquids in the blender jar.
- Avoid bumping or dropping the blender when in operation or at any time.

Blending Drinks

TYPE OF DRINK	INGREDIENTS	NUMBER OF SERVINGS	BLENDER SETTING/TIME
Fruit Smoothie	1 cup (237 ml) milk 1 1/2 cups (355 ml) yogurt 2 cups (473 ml) frozen berries or other fruit Sweetener to taste (optional)	3 to 4 (makes 4 cups [946 ml])	SMOOTHIE setting for 45 seconds or until blended
Milkshake	1 1/2 cups (355 ml) milk 2 large scoops ice cream 2 to 3 Tablespoons (15 to 44 ml) flavored syrup	2 to 3 (makes 3 cups [710 ml])	MIX/MILKSHAKE setting for 5 to 10 seconds or until blended.
Frozen Drink	1 cup (237 ml) drink mix, such as Piña Colada mix 10 ice cubes	2 (makes 2 cups [473 ml])	PURÉE/ICY DRINK setting for 45 seconds or PULSE 5 times and blend on PURÉE/ICY DRINK for 45 seconds or until blended.

TIPS FOR BEST RESULTS:

- Always place liquid in blender jar first, then remaining ingredients.
- If frozen fruit or ice are not blending, stop blender and pulse a few times.

Blending Food

FOOD	QUANTITY	PREPARATION	BLENDING TIME
Parmesan Cheese	10 oz. (283 g)	1/2-in. (1.3-cm) chunks	15 seconds
Baking Chocolate	2 oz. (57 g)	Coarsely chop squares	15 seconds
Nuts	1 cup (237 ml)	None	5 seconds
Chopped Vegetables	2 cups (473 ml)	Cut into 1-in. (2.5-cm) pieces, cover with water	10 seconds
Cookie or Cracker Crumbs	1 cup (237 ml)	Break cookies or crackers into pieces	5 seconds

TIPS FOR BEST RESULTS:

- Use PULSE button with guidelines outlined in chart.
- Remove jar from base and shake to redistribute pieces.
- Place jar on base and pulse a few more times until desired consistency is reached.
- Parmesan cheese should remain refrigerated prior to blending.

Cleaning Your Blender

⚠ WARNING Electrical Shock Hazard.

Disconnect power before cleaning. Do not immerse cord, plug, base, or motor in water or other liquid.

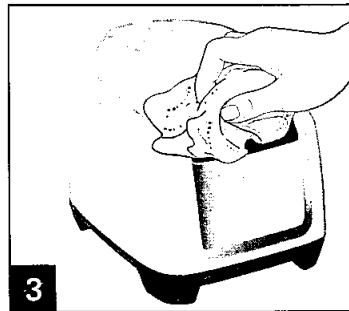
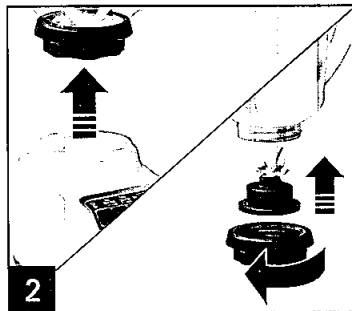
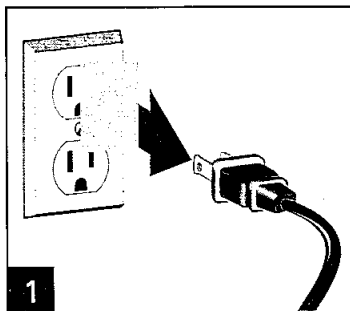

Wipe blender base, control panel, and cord with a damp cloth or sponge. To remove stubborn spots, use a mild, nonabrasive cleanser.



DISHWASHER-SAFE

DO NOT use the "SANI" setting when washing in the dishwasher. "SANI" cycle temperatures could damage your product. Parts may also be washed with hot, soapy water. Care should be taken when handling the cutting blade assembly as it is very sharp. Rinse and dry thoroughly. Do not soak.

Limited Warranty

This warranty applies to products purchased and used in the U.S. and Canada. This is the only express warranty for this product and is in lieu of any other warranty or condition.

This product is warranted to be free from defects in material and workmanship for a period of five (5) years from the date of original purchase in Canada and three (3) years from the date of original purchase in the U.S. During this period, your exclusive remedy is repair or replacement of this product or any component found to be defective, at our option; however, you are responsible for all costs associated with returning the product to us and our returning a product or component under this warranty to you. If the product or component is no longer available, we will replace with a similar one of equal or greater value.

This warranty does not cover glass, filters, wear from normal use, use not in conformity with the printed directions, or damage to the product resulting from accident, alteration, abuse, or misuse. This warranty extends only to the original consumer purchaser or gift recipient. Keep the original sales receipt, as proof of purchase is required to make a warranty claim. This warranty is void if the product is used for other than single-family household use or subjected to any voltage and waveform other than as specified on the rating label (e.g., 120V ~ 60 Hz).

We exclude all claims for special, incidental, and consequential damages caused by breach of express or implied warranty. All liability is limited to the amount of the purchase price. **Every implied warranty, including any statutory warranty or condition of merchantability or fitness for a particular purpose, is disclaimed except to the extent prohibited by law, in which case such warranty or condition is limited to the duration of this written warranty.** This warranty gives you specific legal rights. You may have other legal rights that vary depending on where you live. Some states or provinces do not allow limitations on implied warranties or special, incidental, or consequential damages, so the foregoing limitations may not apply to you.

To make a warranty claim, do not return this appliance to the store. Please call 1.800.851.8900 in the U.S. or 1.800.267.2826 in Canada or visit hamiltonbeach.com in the U.S. or hamiltonbeach.ca in Canada. For faster service, locate the model, type, and series numbers on your appliance.